

Carter 1 Meetinghouse AP Placement Report v2



Completed by: **Jon Loutensock**
Completion date: 08/26/2025

Carter 1 Meetinghouse AP Placement Report v2

Project description
<p>The AP placement and signal strength predictions are based on assumptions made for signal propagation through interior wall materials. Based on those assumptions there will be a greater margin of error between the prediction and what may be experienced.</p> <p>Interior wall material was set as hollow block (cinderblock).</p> <p>Without measured attenuation and AP signal deviation measurements, the actual signal propagation will vary.</p> <p>The AP placement was made based on optimizing 5 GHz signals for primary signal strength. Secondary coverage was not a requirement.</p> <p>The C9172I access point is represented in this prediction.</p> <p>v.2 – Moved access points from inaccessible areas and added an access point to keep the same coverage.</p>

Carter 1 Meetinghouse - Floor Plan

Survey routes and Access Points for Carter 1 Meetinghouse - Floor Plan

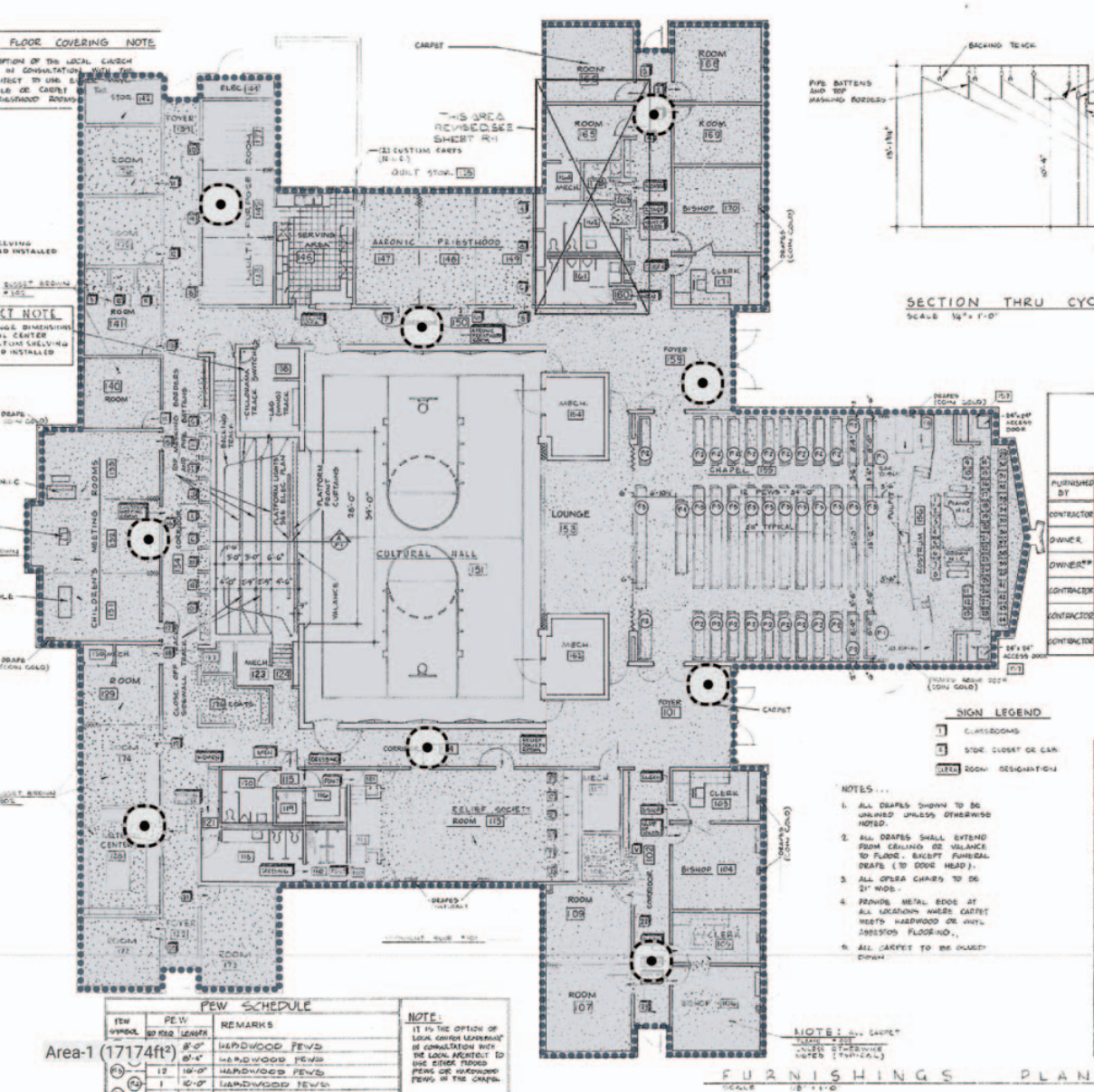

View as / Project Offset:

Mobile Device

Area-1 (17,174 ft²)

Coverage Requirement: Ekahau Best Practices		
2.4 GHz	Signal Strength Min	-75.0 dBm

Carter 1 Meetinghouse AP Placement Report v2

	Signal-to-Noise Ratio Min	20.0 dB
	Data Rate Min	24 Mbps
	Channel Interference Max	2 at min. -85.0 dBm
	Round Trip Time (RTT) Max	200 ms
	Packet Loss Max	0.0 %
5 GHz	Signal Strength Min	-75.0 dBm
	Secondary Signal Strength Min	-67.0 dBm
	Signal-to-Noise Ratio Min	25.0 dB
	Data Rate Min	24 Mbps
	Channel Interference Max	1 at min. -85.0 dBm
	Round Trip Time (RTT) Max	200 ms
	Packet Loss Max	0.0 %
6 GHz	Signal Strength Min	-75.0 dBm
	Secondary Signal Strength Min	-67.0 dBm
	Signal-to-Noise Ratio Min	25.0 dB
	Data Rate Min	24 Mbps
	Channel Interference Max	1 at min. -85.0 dBm
	Round Trip Time (RTT) Max	200 ms
	Packet Loss Max	0.0 %
Capacity Requirement	No capacity devices for this area	
Notes		

Signal Strength for Carter 1 Meetinghouse - Floor Plan on 5 GHz band

Signal Strength - sometimes called coverage - is the most basic requirement for a wireless network. As a general guideline, low signal strength means unreliable connections, and low data throughput.

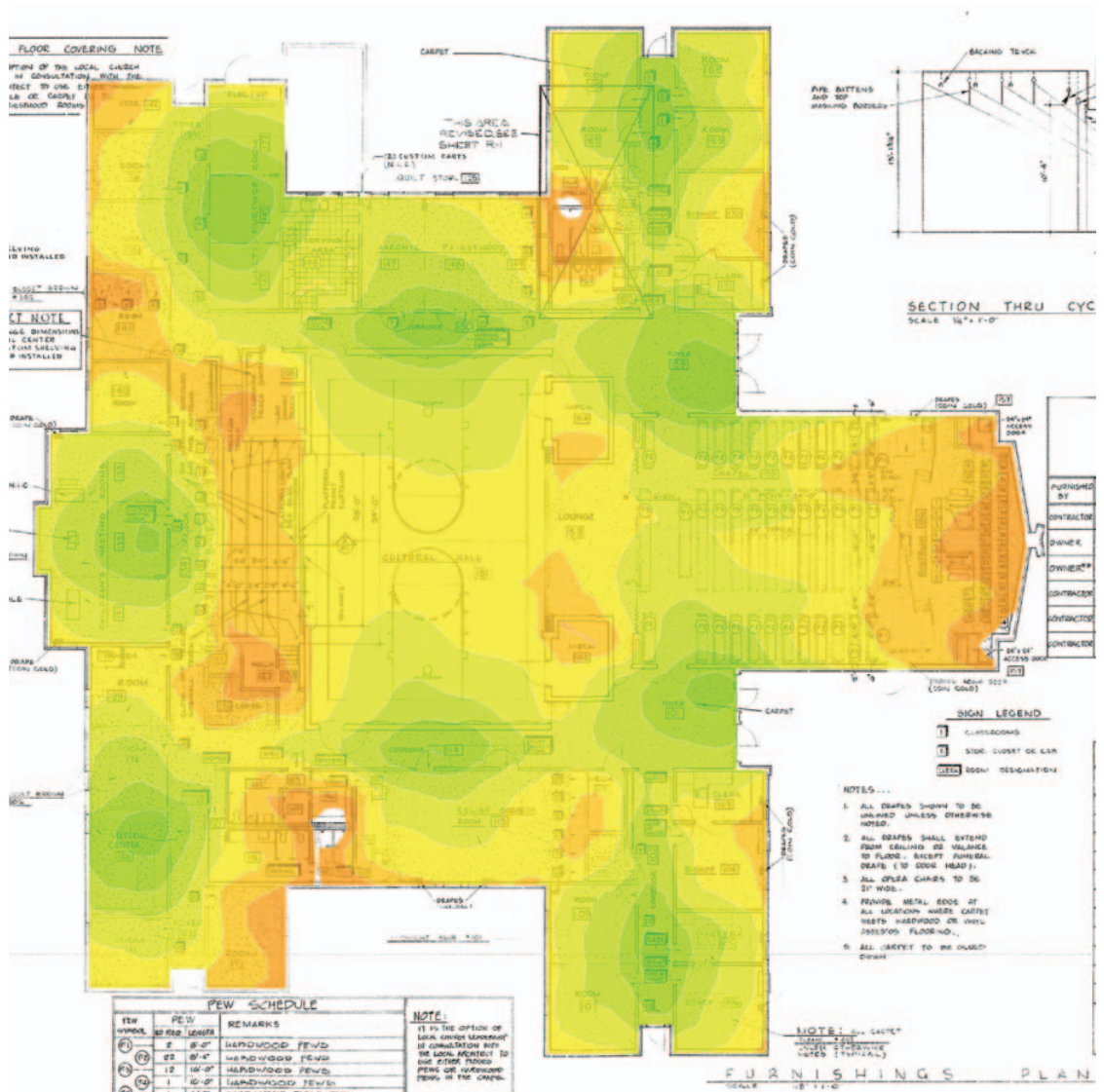



Access Points on Carter 1 Meetinghouse - Floor Plan

Simulated Access Points on Carter 1 Meetinghouse - Floor Plan

AP #	Access Point			
1	Simulated AP-001		Cisco CW9172I	
	Wi-Fi 7	11	8.0 dBm	Cisco CW9172I 2.4GHz
	Wi-Fi 7	64	14.0 dBm	Cisco CW9172I 5GHz
	Wi-Fi 7	149@80 (6 GHz)	14.0 dBm	Cisco CW9172I 6GHz
	Bluetooth	-	0.0 dBm	Cisco CW9172I BLE
2	Simulated AP-002		Cisco CW9172I	
	Wi-Fi 7	6	14.0 dBm	Cisco CW9172I 2.4GHz
	Wi-Fi 7	149	14.0 dBm	Cisco CW9172I 5GHz
	Wi-Fi 7	53@80 (6 GHz)	14.0 dBm	Cisco CW9172I 6GHz
	Bluetooth	-	0.0 dBm	Cisco CW9172I BLE
3	Simulated AP-003		Cisco CW9172I	
	Wi-Fi 7	1	8.0 dBm	Cisco CW9172I 2.4GHz
	Wi-Fi 7	108	14.0 dBm	Cisco CW9172I 5GHz
	Wi-Fi 7	181@80 (6 GHz)	14.0 dBm	Cisco CW9172I 6GHz
	Bluetooth	-	0.0 dBm	Cisco CW9172I BLE
4	Simulated AP-004		Cisco CW9172I	
	Wi-Fi 7	1	14.0 dBm	Cisco CW9172I 2.4GHz
	Wi-Fi 7	36	14.0 dBm	Cisco CW9172I 5GHz
	Wi-Fi 7	213@80 (6 GHz)	14.0 dBm	Cisco CW9172I 6GHz
	Bluetooth	-	0.0 dBm	Cisco CW9172I BLE
5	Simulated AP-005		Cisco CW9172I	
	Wi-Fi 7	11	14.0 dBm	Cisco CW9172I 2.4GHz
	Wi-Fi 7	165	14.0 dBm	Cisco CW9172I 5GHz
	Wi-Fi 7	101@80 (6 GHz)	14.0 dBm	Cisco CW9172I 6GHz

Carter 1 Meetinghouse AP Placement Report v2

	Bluetooth	-	0.0 dBm	Cisco CW9172I BLE
6	Simulated AP-006		Cisco CW9172I	
	Wi-Fi 7	6	8.0 dBm	Cisco CW9172I 2.4GHz
	Wi-Fi 7	48	14.0 dBm	Cisco CW9172I 5GHz
	Wi-Fi 7	165@80 (6 GHz)	14.0 dBm	Cisco CW9172I 6GHz
	Bluetooth	-	0.0 dBm	Cisco CW9172I BLE
7	Simulated AP-007		Cisco CW9172I	
	Wi-Fi 7	11	8.0 dBm	Cisco CW9172I 2.4GHz
	Wi-Fi 7	100	14.0 dBm	Cisco CW9172I 5GHz
	Wi-Fi 7	1@80 (6 GHz)	14.0 dBm	Cisco CW9172I 6GHz
	Bluetooth	-	0.0 dBm	Cisco CW9172I BLE
8	Simulated AP-008		Cisco CW9172I	
	Wi-Fi 7	6	8.0 dBm	Cisco CW9172I 2.4GHz
	Wi-Fi 7	132	14.0 dBm	Cisco CW9172I 5GHz
	Wi-Fi 7	5@80 (6 GHz)	14.0 dBm	Cisco CW9172I 6GHz
	Bluetooth	-	0.0 dBm	Cisco CW9172I BLE
9	Simulated AP-009		Cisco CW9172I	
	Wi-Fi 7	1	8.0 dBm	Cisco CW9172I 2.4GHz
	Wi-Fi 7	116	14.0 dBm	Cisco CW9172I 5GHz
	Wi-Fi 7	117@80 (6 GHz)	14.0 dBm	Cisco CW9172I 6GHz
	Bluetooth	-	0.0 dBm	Cisco CW9172I BLE